

3416 3417 3418



Air operated rocker arm welding machine with microprocessor welding control unit TE90.

Arms adjustable in length according to the job to be carried out. Chrome-copper electrode holders for long life and heavy duty service, designed for straight and angled fitting. Adjustable electrode stroke to have the maximum working rate.

Epoxy coated water-cooled transformer. Water-cooled arms, electrode holders and electrodes. Synchronous SCR contactor insulated from cooling water circuit and protection thermostat.

Two-stage electric foot switch, that besides its normal use in automatic and single spot mode, allows the operator to bring the pieces together and to weld them only when correctly positioned. Pre-arrangement for the connection of a second electric two-stage foot switch item 70284. The addition of the second foot switch allows to recall two different adjustments of time and current, required when different kinds of welding are to be performed on the same piece. Single and automatic repeat modes.

Item	3416	3417	3418	
Supply voltage	*400	*400	*400	V
Mains frequency	*50 / 60	*50 / 60	*50 / 60	Hz
Mains protection (delayed)	32	40	50	A
Nominal power 50% ED	16	20	25	kVA
Maximum welding power	32	44	62	kVA
Maximum secondary voltage	9,4	11,2	13,2	kA
Thermal current 100%	3,3	3,5	3,8	kA
No load secondary voltage	3,4	4	4,6	V
Weld time	1÷99	1÷99	1÷99	cycles
Protection rating	21	21	21	IP
Weight	112	117	125	kg

* Different voltages and frequencies on demand

Selection of Arms, Electrodes and Accessories

3436



Additional foot control for program no. 2

3444

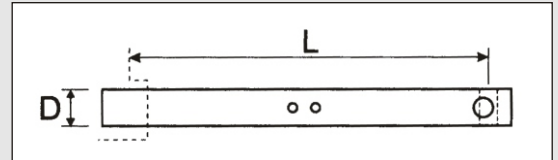

Brass arm without electrode-holder
D=36 mm L=380÷700 mm (Item 3407-3411-3417)

3445

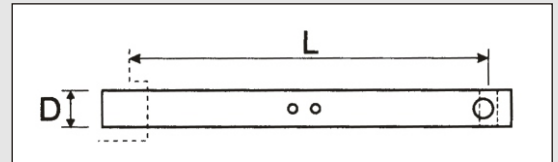

Brass arm without electrode-holder
D=40 mm L=380÷700 mm (Item 3408-3415-3418)

3446 - 3447

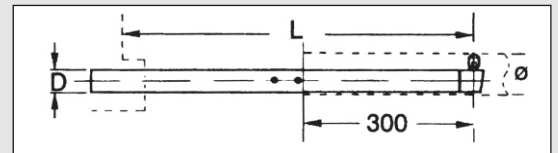

Reduced size brass arm.
D=36 mm - L=380÷700 mm - ø62 mm (Item 3446 for 16-20 kVA)
D=40 mm - L=380÷700 mm - ø70 mm (Item 3447 for 25 kVA)

3448 - 3449

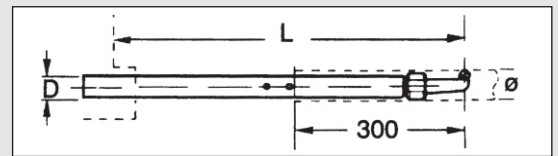

Reduced size brass arm.
D=36 mm - L=380÷700 mm - ø48 mm (Item 3448 for 16-20 kVA)
D=40 mm - L=380÷700 mm - ø48 mm (Item 3449 for 25 kVA)

3566 - 3567 - 3569

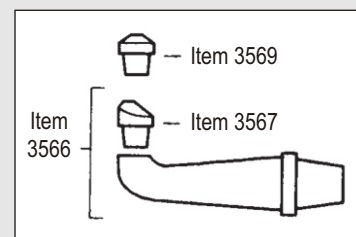

Item. 3566 Electrode-holder with ring nut, couplings and electrode item 3567
Item 3567 Offset electrode for item 3566
Item 3569 Straight electrode for item 3566